

RESOLUTION NO. 546

A RESOLUTION ANNEXING INTO THE CITY OF STAYTON CERTAIN REAL PROPERTY LOCATED AT THE EAST END OF EAST VIRGINIA STREET AND AT 1520 EAST JEFFERSON STREET.

WHEREAS, Daniel E. and Marilyn J. Brammer, Lawrence and Glenna R. Grames, and I. B. Ray and Evelyn Brumbaugh are owners of a 14.63-acre tract at the east end of East Virginia Street, Assessor's Tax Lot Numbers 60954-960 and 61053-000, situated in Marion County, State of Oregon; and

WHEREAS, on 1 May 1991, owners filed with the City of Stayton, Oregon pursuant to ORS 222.125 and Stayton Code Section 17.12.460 and 17.12.490, an annexation application and site plan review application for the Parkview Subdivision; and

WHEREAS, the City of Stayton Planning Commission and City Council held public hearings as required by law and on 5 August 1991 the Stayton City Council adopted Order No. 08-05/91, granting approval to the annexation subject to execution of a contract annexation agreement between the applicants and the city and compliance with certain conditions of approval; and

WHEREAS, on 29 December 1993 the applicants submitted a proposal for Parkview Subdivision; and

WHEREAS, the Stayton Planning Commission and City Council held public hearings on the proposed subdivision as required by law, and on 16 May 1994, the council adopted an Order of Approval for Parkview Subdivision [File No. 20-12/93--approving Phases 1 & 2]; and

WHEREAS, the subject property is within the Stayton urban growth boundary, contiguous to the existing corporate city limits, with a land use designation of Low Density (LD) Residential;

NOW, THEREFORE, BE IT RESOLVED by the City Council of the City of Stayton, Oregon

SECTION 1. That pursuant to ORS 221.125, the Stayton City Council hereby initiates proceedings and proclaims the annexation to the City of Stayton, Oregon, of territory lying contiguous to the present city limits, located at the east end of East Virginia Street and at 1029 East Jefferson Street, which is described in Reel 885, Page 439, of the Marion County Deed Records, and is described as follows:

Beginning at the initial corner of this subdivision which is a 5/8 inch by 30 inch iron rod with a yellow plastic cap stamped "Barker PLS 636" on the north boundary line of that tract of land conveyed to Daniel E. Brammer and Marilyn J. Brammer, et al, by deed recorded in Reel 885, Page 439, Deed Records for Marion County Oregon, which point bears South 00° 38' 04" East 731.50 feet, and North 89° 21' 47" East 387.65 feet from the Quarter corner of the west line of Section 11, Township 9 South, Range 1 West of the Willamette Meridian in Marion County, Oregon; thence North 89° 21' 47" East along the North line of said Brammer tract, a distance of 842.77 feet to the southwest corner of that tract of land conveyed to Richard Schotthoefer and Gertrude Schotthoefer by deed recorded in Volume 300, Page 685, Deed Records; thence North 0° 42' 53" West along the west line of

RESOLUTION NO. 546

Annexing Property at the east end of E. Virginia Street (Parkview Subdivision)

Page 1 of 2

said Schotthoefer tract, a distance of 306.73 feet to a point on the south right-of-way line of E. Jefferson Street; thence North 89° 19' 00" East along said right-of-way line, a distance of 117.00 feet; thence South 0° 42' 53" East 533.06 feet; thence North 89° 21' 47" East 5.00 feet; thence South 0° 42' 53" East 401.70 feet to a point on the south line of said Brammer tract; thence South 89° 22' 48" West along said south line a distance of 962.05 feet to a point on the east line of that tract of land conveyed to James R. Lande and Elsie Lande by deed recorded in Volume 581, Page 561, Deed Records; thence North 0° 31' 44" West along said East line, a distance of 105.00 feet to the northeast corner thereof; thence North 7° 07' 48" East 45.41 feet; thence North 0° 38' 13" West 206.41 feet; thence North 10° 05' 58" West 60.83 feet; thence North 0° 38' 13" West 166.24 feet to the point of beginning and containing 14.6344 acres of land, more or less.

- SECTION 2. That pursuant to ORS 221.005 the City Administrator shall provide by certified mail to all public utilities, telecommunications utilities, and franchise holders operating within the city a written notice of each site address to be annexed as recorded on the Marion County assessment and tax rolls, a legal description and map of the proposed boundary change, and a copy of this resolution. This notice shall be mailed within ten (10) working days of the passage of this resolution,
- SECTION 3. That pursuant to ORS 221.010 the City Administrator shall, within ten (10) working days of the passage of this resolution, provide to the Oregon Department of Revenue, Marion County Clerk and Marion County Assessor a report of the annexation including a detailed legal description of the new boundaries established by the City.

PASSED BY THE CITY COUNCIL this 18th day of July, 1994.

Date: 7-25-94

By:

Willmer Van Vleet
WILLMER VAN VLEET, Mayor

ATTEST

Date: 7-25-94

By:

David W. Kinney
DAVID W. KINNEY, City Administrator

RESOLUTION NO. 546

Annexing Property at the east end of E. Virginia Street (Parkview Subdivision)

Page 2 of 2

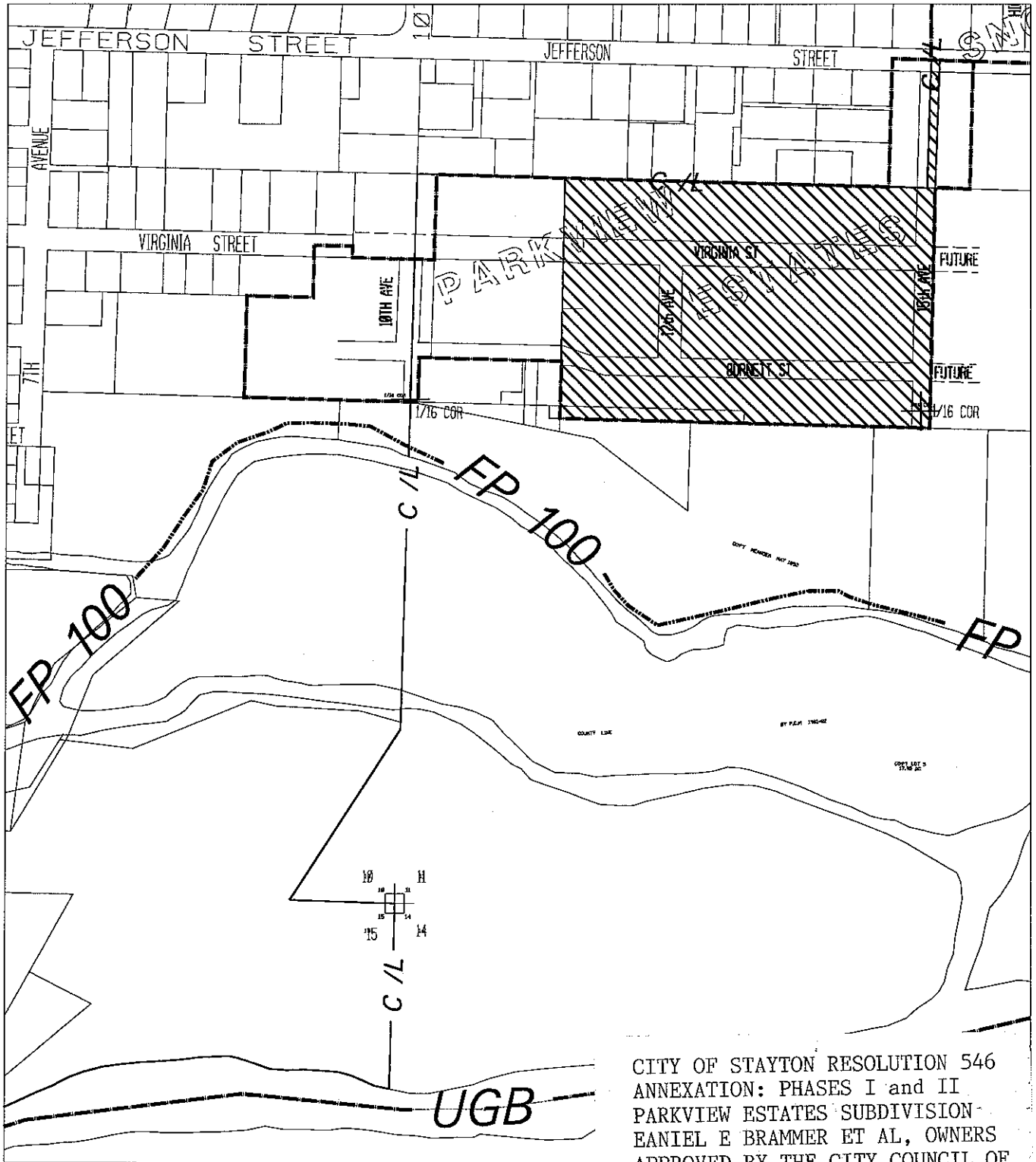

CITY OF STAYTON RESOLUTION 546
 ANNEXATION: PHASES I and II
 PARKVIEW ESTATES SUBDIVISION
 EANIEL E BRAMMER ET AL, OWNERS
 APPROVED BY THE CITY COUNCIL OF
 THE CITY OF STAYTON 7-18-94
 (vote: 4:1)

PLATES - PHAS I
OF STAYTON, MARION C

S.W. 1/4

BRASS CAP
BOX

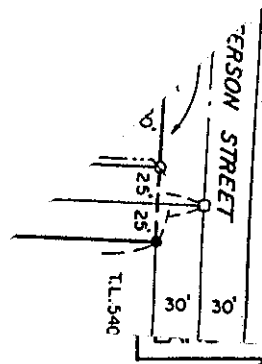

Clarence E. Barker
OREGON
JULY 10, 1964
CLARENCE E. BARKER
636

EXPIRES 12-31-95

N 89° 21' 47" E 387.65'

BARKER SURVEYING CO.
2035 25TH STREET S.E.
SALEM, OREGON 97302
PHONE 588-8800

N 10° 05' 58" W 60' 9° 21' 47" E

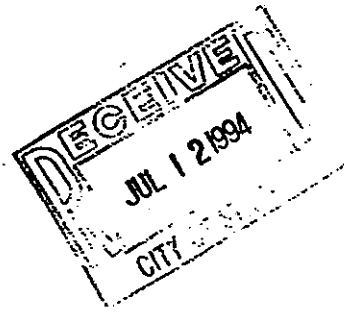

Phase I
Phase II

N 7° 07' 48" E

3/4" IP
TOP (C

S 89° 22' 48" W 1309.80'

3/4" IP (SHOWN
IN CS 104201