

RESOLUTION NO. 574

A RESOLUTION INITIATING COMPREHENSIVE PLAN DESIGNATION/ZONING MAP AMENDMENTS FOR PROPERTY LOCATED ON FOURTH AVENUE AT FLORENCE STREET.

WHEREAS, the City of Stayton has acquired property identified as Tax Lot No. 60909-000 within the City of Stayton; and

WHEREAS, the City of Stayton desires to develop property for public purposes; and

WHEREAS, the city wishes to initiate a land use application to amend the Stayton Comprehensive Plan to redesignate the site from the Light Industrial (IL) zone to Public/Semi-Public (P);

NOW, THEREFORE, be it resolved by the Stayton City Council that:

1. The Stayton City Council hereby authorizes submittal by city staff of land use applications to amend the Stayton Comprehensive Plan and Zoning Map to redesignate and rezone property on Fourth Avenue at Florence Street (Tax Lot No. 60909-000), identified on the map attached as Exhibit A., from Light Industrial (IL) to Public/Semi-Public (P).
2. The Stayton City Council hereby refers this matter to the Stayton Planning Commission to consider amendments to the Stayton Comprehensive Plan and Zoning Map to rezone property on Fourth Avenue at Florence Street (identified on the map attached as Exhibit A. and described in the property description attached as Exhibit B.), and to make recommendation to the Stayton City Council.

ADOPTED BY THE STAYTON CITY COUNCIL this 21st day of August 1995.

Date: 8-24-95

By:

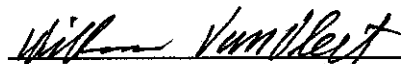

WILLMER VAN VLEET, Stayton City Council

Date: 8/22/95

Attest:

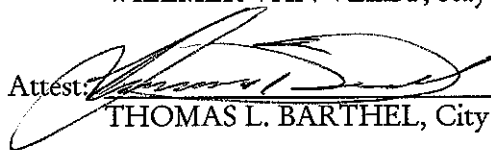

THOMAS L. BARTHEL, City Administrator

EXHIBIT A.  
Resolution No. 574

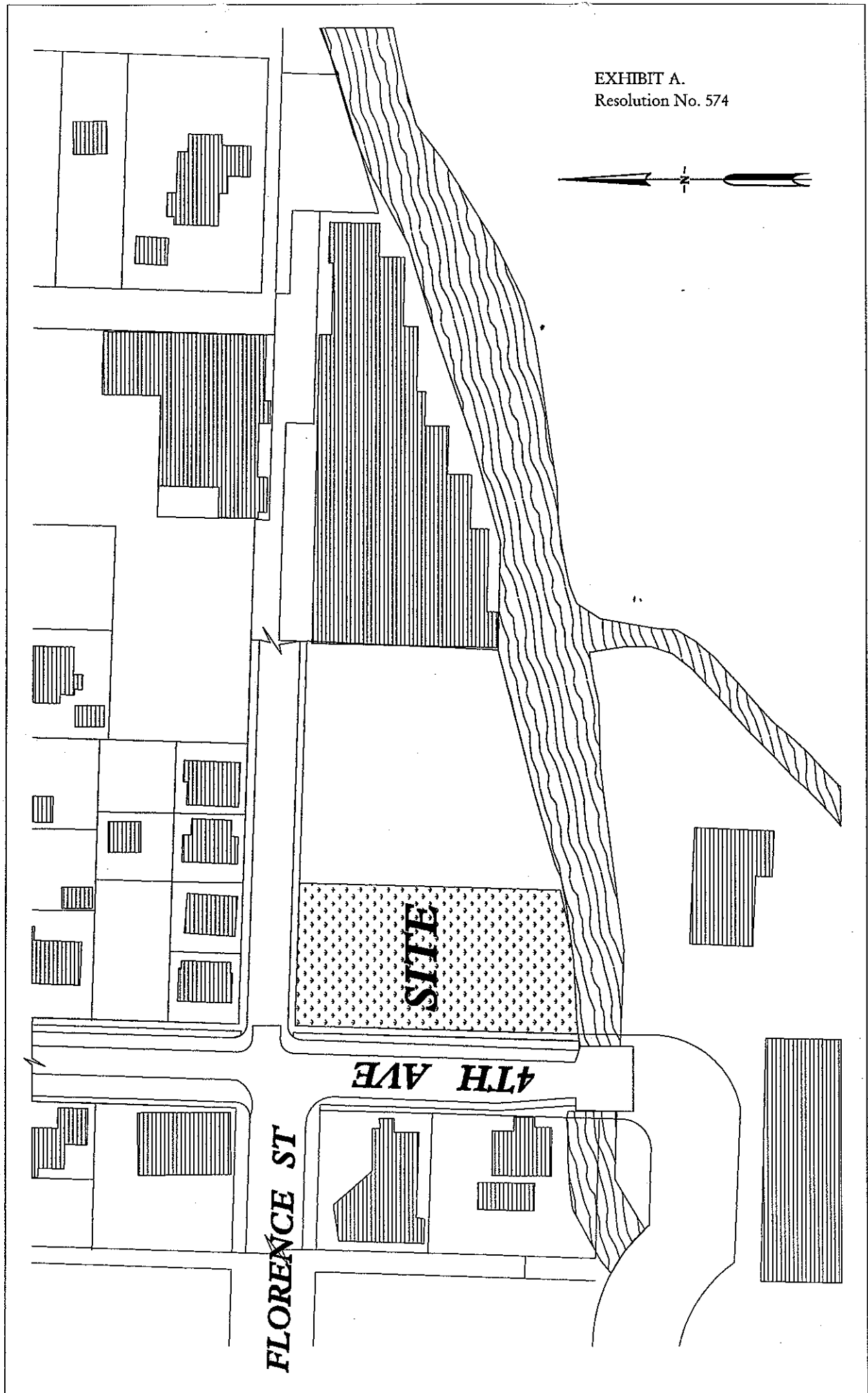
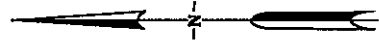

**FLORENCE ST**

**4TH AVE**

**SITE**

PROPERTY DESCRIPTION

Tax Lot No. 60909-000  
Fourth Avenue at Florence Street

Beginning at a point 40 feet south and 60 feet east of the southeast corner of a tract of land described in a deed recorded at Page 86 of Volume 15 of the Deed Records of Marion County, Oregon and known as the Mulkey Block on the recorded plat of the Town of Stayton, Oregon; thence south 3.06 chains to a point within 2 feet of the water's edge in the mill race formerly known as D. S. Stayton's; thence in a northeasterly direction following the meanderings of said mill race and along the north bank thereof until a point is reached which is 4.18 chains east of the first course above given; thence north 2.08 chains; thence west 4.18 chains to the place of beginning, situated in the Stephen Porter Donation Land Claim in Township 9 South, Range 1 West of the Willamette Meridian in Marion County, Oregon.

SAVE AND EXCEPT therefore the east 175 feet, as more particularly described in a deed from the above grantor to R. D. Paris and wife recorded in Volume 217, Page 259 of the Deed Records of Marion County, Oregon.

Be it understood that if the above described property or any portion thereof is used for purposes other than public use, title to the entire property shall automatically revert to and vest in grantor.